

# Loft

design by Adriano Piazzi 2003



**Structure:** varnished metal.

**Seat padding:** non-deformable polyurethane (T35; HR35-36; PK30; HD60) covered by synthetic lining.

**Arm and back padding:** non-deformable polyurethane (PK30) covered by coupled 6mm synthetic lining.

**Cushions padding:** cotton cover filled with mixed down.

**Springing:** elastic belts.

**Seat height:** 36 cm

**Arm height:** 54 cm

**Feet:** inox steel, h. 10 cm.

**Tray:** in mat stainless steel with top in polished stainless steel.

**Attention:** the sectional units cannot be supplied as single elements.  
**On request the units can be shipped disassembled.**

**Struttura:** metallo verniciato.

**Imbottitura seduta:** poliuretano indeformabile (T35; HR35-36; PK30; HD60), fodera in tomana.

**Imbottitura bracciolo e schienale:** poliuretano indeformabile (PK30), fodera in accoppiato 6 mm.

**Spalliera:** cotone riempitura fiocco piuma.

**Piano di molleggio:** cinghie elastiche

**Altezza seduta:** 36 cm

**Altezza bracciolo:** 54 cm

**Piedi:** acciaio inox, h. 10 cm.

**Vassoio:** in acciaio inox satinato con piano in acciaio inox lucido.

**Attenzione:** Gli elementi componibili non si possono realizzare a solo.  
**Su richiesta gli elementi possono essere inviati smontati.**

1) The units are supplied with a patented mechanism which enables to adjust the seat depth.

2) The sofas are supplied with split independently-adjustable back, which permits two different seat depths at the same time.

3) Backrest height adjustable.

1) Gli elementi sono forniti di un meccanismo brevettato che permette di modificare la profondità di seduta.

2) I divani sono forniti di un doppio movimento che consente di avere contemporaneamente due profondità di seduta.

3) Lo schienale è regolabile in altezza.

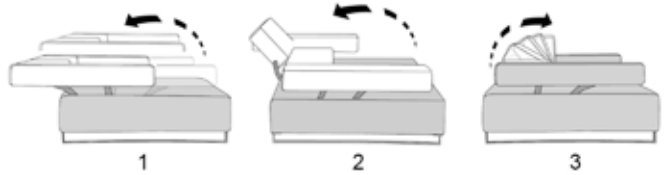

In order to avoid any damages to the mechanism, please DO NOT sit on armrests and backs.

Per evitare danni al meccanismo di movimento, si prega di NON sedersi sui braccioli e sugli schienali.



**Sofa with split independently-adjustable back**

Divano con doppio movimento

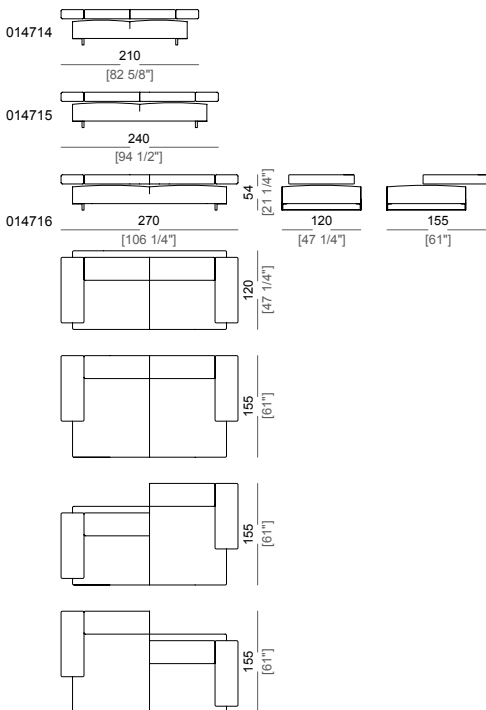

**Right or left unit**

Elemento laterale dx o sx

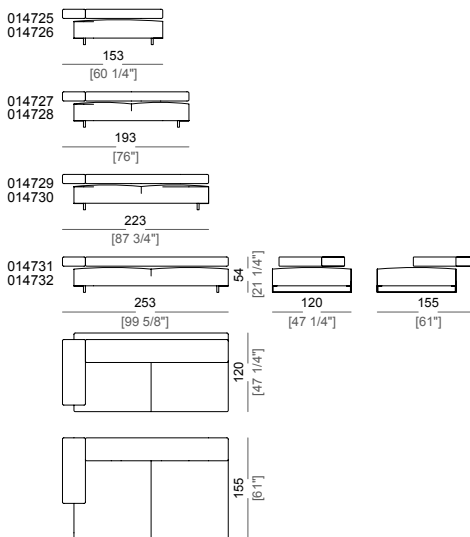

**Chaise-longue with right or left short arm**  
Chaise longue dx o sx

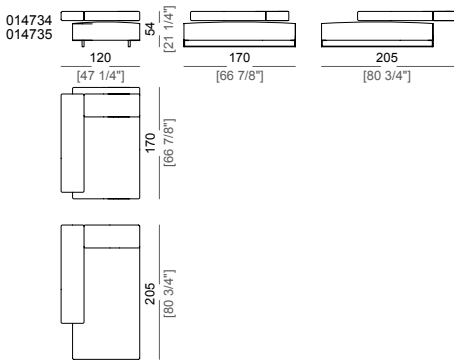

**Armchair**  
Poltrona

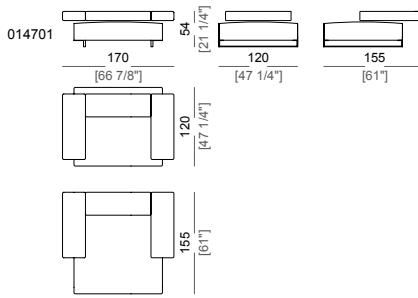

**Corner pouf**  
Pouf angolare

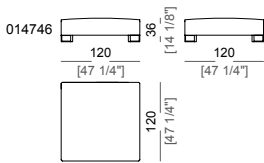

**Pouf**  
Pouf

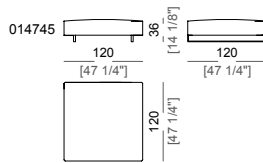

**Pouf**  
Pouf

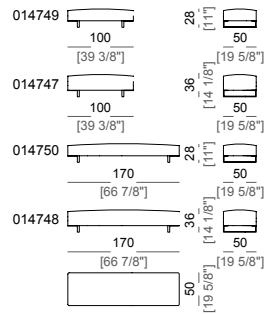

**Composition A**  
Composizione A

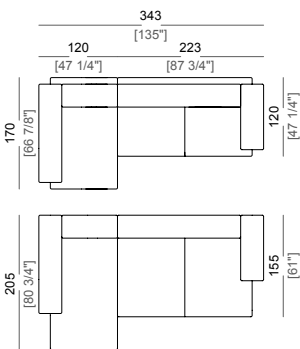

**Composition B**  
Composizione B

